



Cyclone®

Innovation by Design - Since 1991

BX600

CLASSIC COLLECTION

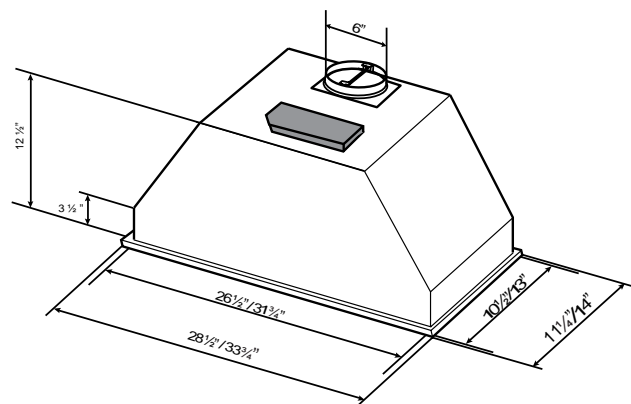

Insert

Cyclone's newest insert is discreet and quiet yet bold and powerful enough to leave a distinct impression. Powered at 600 CFM and fitted with dishwasher safe stainless steel baffle filters angled at 45 degrees to maximize ventilation. Comes equipped with three speed push buttons and two bright LED lights. The sleek BX600 range hood cannot be seen from eye level, designed to fit into your custom wood canopy. Available in 28" and 34" widths.

Specifications

Air Flow Volume: 600 CFM

Electrical Connection: 120V/60Hz

Electrical Consumption: 200 Watts

Fan Speed: 1356 RPM

Finishes: Stainless Steel

Venting: 6" Round - Top Only

Dimensions: Width: 28"/34"

Height: 12 1/2"

Depth: 10 1/4"/13"

Sones: Min. 2 Max. 6



FRENDEL
KITCHENS LIMITED

www.frendel.com



C US

Model	Colour	Venting	Size
BX60028	Stainless Steel	6"	28"
BX60034	Stainless Steel	6"	34"

IMPORTANT SAFETY INSTRUCTIONS

WARNING

- This appliance must be installed by a qualified technician.
- The manufacturer declines all responsibilities in the event of failure to observe the instructions given here for installation, maintenance and suitable use of the product.
- The manufacturer further declines all responsibility for injury due to negligence, and the warranty of the unit automatically expires due to improper installation and maintenance.

CAUTION

- For indoor use only.
- For residential cooking use only. Do not use to exhaust hazardous or explosive materials or vapors.
- Two installers are recommended because of the size and weight of this hood.
- Do not use more than 20 watts per halogen lightbulb for this model.
- Light bulbs combined are not to exceed 40 watts. Use Type G4, 12V, 20W Maximum, halogen bulb for SS130.

WARNING

TO REDUCE THE RISK OF RANGE TOP GREASE FIRE:

1. Never leave the range unattended at high settings.
2. Always turn hood ON when cooking at high heat or when flaming food.
3. Use proper pan size. Always use cookware appropriate for the size of the surface element.
4. Keep fan, filters and grease laden surfaces clean. Clean ventilating fans frequently. Do not allow grease to accumulate on fan or filter.
5. Use HIGH setting on hood only when necessary.
6. Don't leave hood unattended when cooking.
7. To reduce the risk of fire, use only metal ductwork.
8. This unit must be grounded.
9. Not for outdoor use.

WARNING

TO REDUCE THE RISK OF FIRE, ELECTRIC SHOCK, OR INJURY TO PERSONS, OBSERVE THE FOLLOWING:

1. Use this unit only in the manner intended by the manufacturer.
2. Before servicing or cleaning the unit, switch power off at service panel and lock service panel to prevent power from being switched on accidentally. When the service disconnecting means cannot be locked, securely fasten a prominent warning device to the service panel.
3. Installation work and electrical wiring must be done by qualified persons in accordance with all applicable codes and standards, including fire-rated construction.
4. Sufficient air is needed for proper combustion and exhausting of gases through the flue of fuel burning equipment to prevent back drafting. Follow the heating equipment manufacturer's guideline and safety standards as published by the local code authorities.
5. When cutting or drilling into walls or ceilings, be careful not to damage existing electrical wiring and other hidden utilities.
6. To reduce the risk of fire, electric shock and to properly exhaust air, ducted fans must always be vented outdoors. Do not vent exhaust air into spaces within walls, ceilings, attics, crawl spaces, or garages. Do not connect this fan with any solid-state speed control device.
7. Always keep the duct clear to maintain proper airflow for venting.
8. The bottom of the hood MUST NOT BE LESS than 28" and at a suggested maximum of 36" above cooktop for best capture of cooking impurities. For a gas range, the bottom of the hood MUST NOT BE LESS than 30" above cooktop.

WARNING

- Do not repair or replace any part of this appliance unless specifically recommended in this book. All other service should be performed by a qualified technician.
- The hood motor has a thermal overload that will automatically shut off the motor if it becomes overheated. The motor will restart. If the motor continually shuts off and restarts, contact the Cyclone service department. Ensure that the hood is mounted at the recommended mounting height.
- This product may have sharp edges. Be careful to avoid cuts and abrasions during installation and cleaning.

SPECIFICATIONS

Classic Collection Insert - Model: BX600

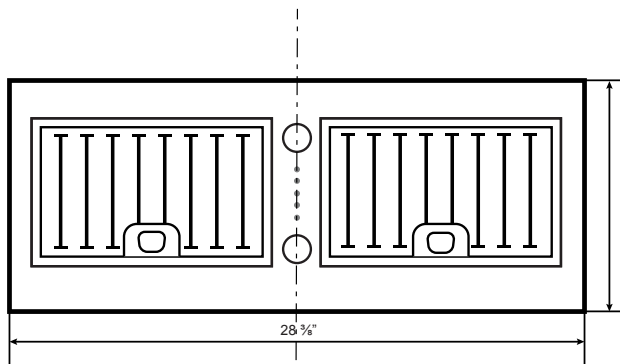
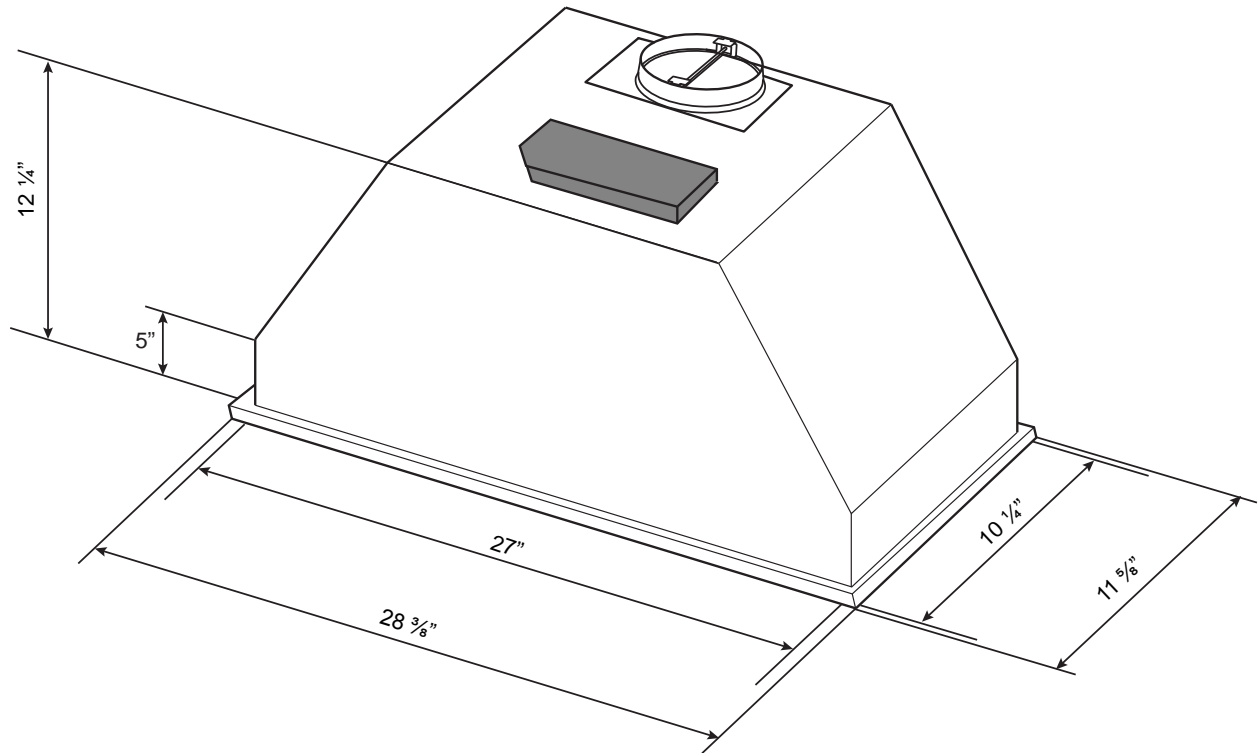

BOTTOM

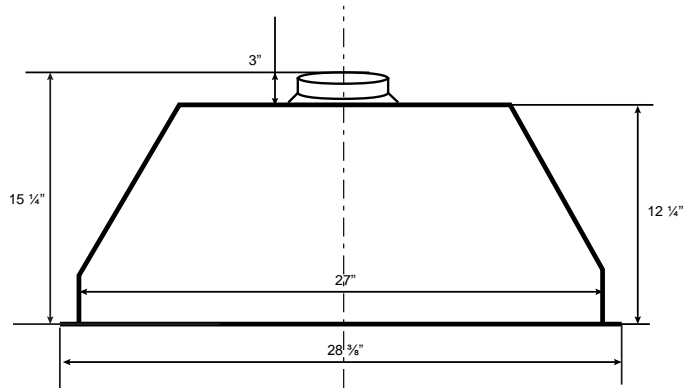

FRONT

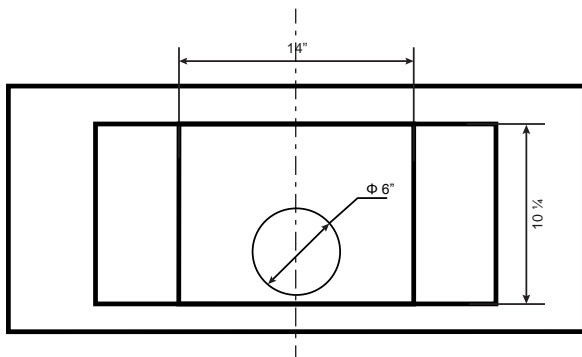

TOP



BX600 INSTALLATION - PARTS SUPPLIED

1 × Hood

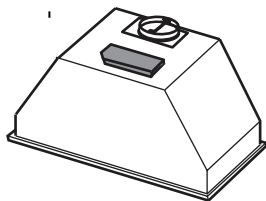

PRE-INSTALLED
1 × Round Adapter

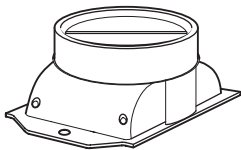

PRE-INSTALLED
2 × LED Lights



1 × Rectangular Oil Collector

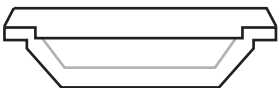

HARDWARE PACKAGE

8 × Mounting Screws

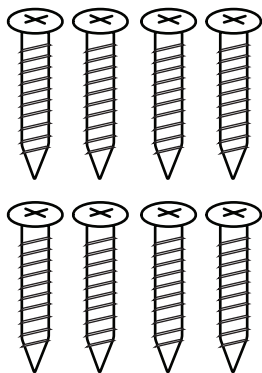

BX600 INSERT HOOD INSTALLATION

This appliance requires 120V 60Hz electrical supply and connection to an individual properly grounded branch circuit protected by a circuit breaker or time delay fuse.

⚠ CAUTION

- At least two installers are required due to the weight and size of the hood.

⚠ WARNING

- Turn off power circuit at the service panel before wiring this unit.
- All electrical work must be done by a qualified electrician in accordance with all applicable codes and standards. This range hood must be properly grounded.

Prepare for Installation

- Unpack range hood and check contents. Note: Be cautious of sharp edges within the unit.
- Cut the insert cutout at the bottom of the cabinet using the given cutout measurements on page 18 (Figure 1).
- Locate the cutout at the center of the bottom of the cabinet.

Figure 1.

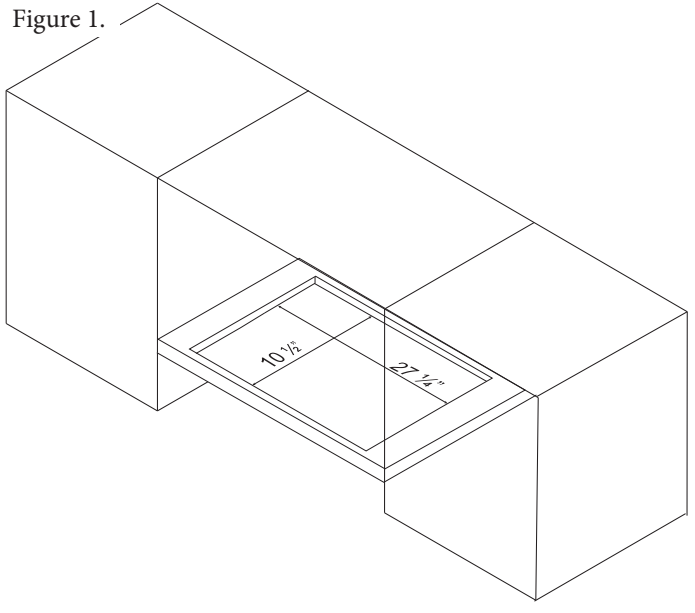

Install the BX600 Range Hood

- Remove outer baffle filters of range hood (Figure 1).

Figure 1.

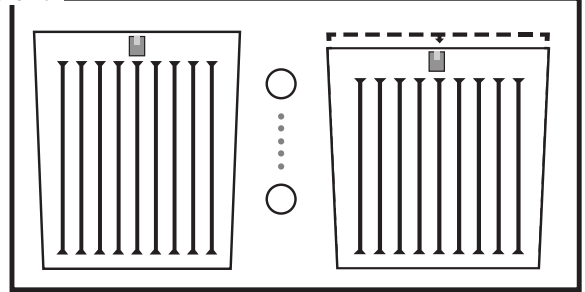

- Hold range hood upright, and insert range hood upward into cabinet cutout. Mount the insert range hood to the cabinet using eight screws from inside the range hood (two screws on each side) (Figure 2).

Figure 2.

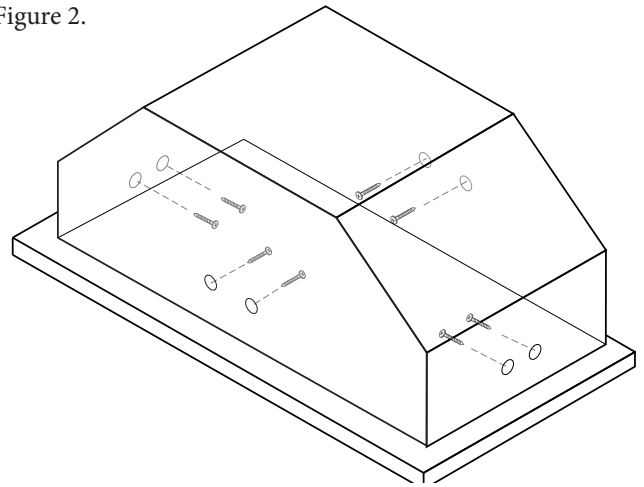

- Place baffle filters back into place.
- Connect the power plug to the junction box.

BX600 INSTALLATION - INSTALLATION CUTOUT TEMPLATES

BX600

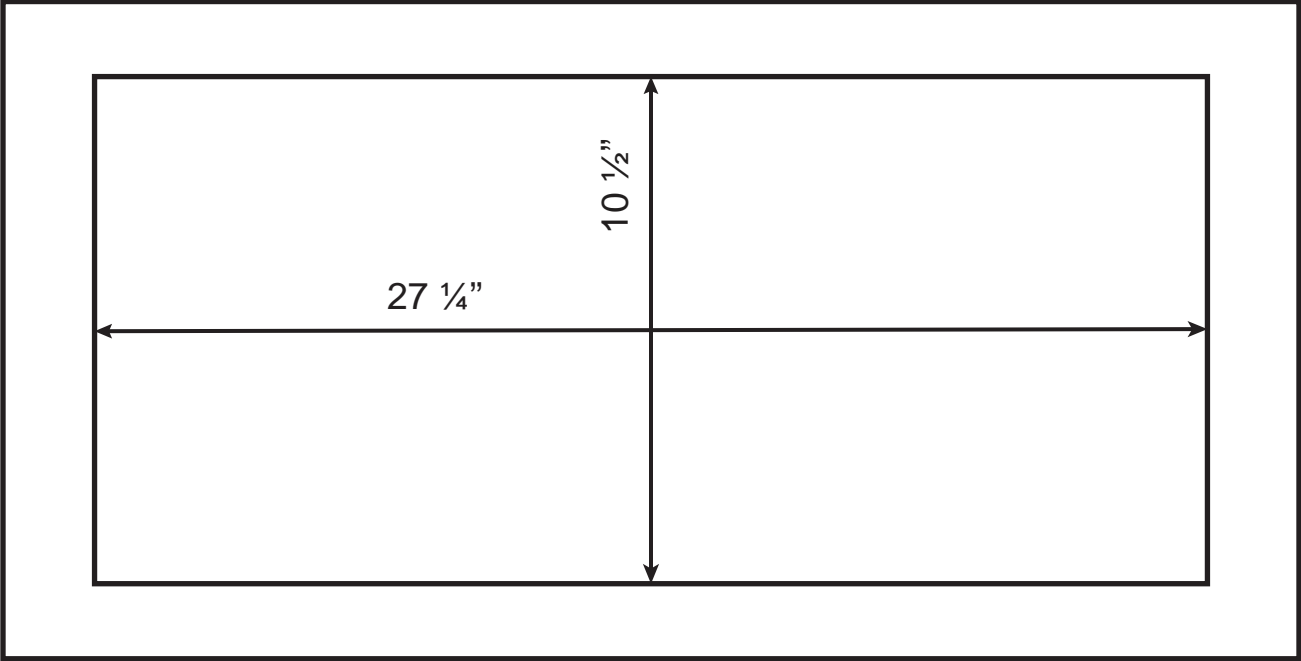

MAINTENANCE

For a complete description of our maintenance and operating instructions you may visit us on-line at www.CycloneRangeHoods.com to download your model's Owner's Manual.

⚠ WARNING

- Always switch off power and unplug before cleaning and maintenance.

Surface and Filter Cleaning:

Clean with warm soapy water and a clean cloth. Do not use corrosive or abrasive detergent or steel wool pads that can scratch the surface of the machine.

Use non-abrasive stainless steel polish to buff out the luster and grain. Scrub lightly.

The stainless steel filters trap residue and grease from cooking. The filters should never have to be replaced but should be cleaned thoroughly every 30 to 60 days depending on cooking habits. Filters may be placed on the top rack of the dishwasher or soaked in warm, soapy water.

Spray degreasing detergent and leave to soak if heavily soiled.

Replacing Lightbulbs:

⚠ WARNING

- Always switch off electrical supply before carrying out any operation on the appliance.
- In order to prevent the risk of personal injury, the halogen lamps must be cooled before removal.
- Use Type G4 12V 20W maximum, halogen bulb for SS130.

To change bulbs for BX2000/BX2010/BX215/BX6000

1. Firmly press fingers against the lightbulb and twist counter-clockwise until bulb is loosened.

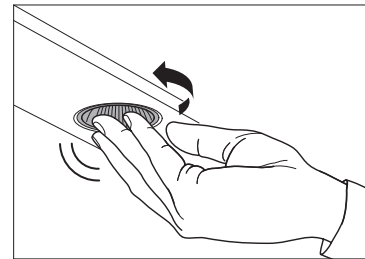

CONTROL PANEL

Model: BX600

The unit is controlled by push buttons.

The fan and lights are each controlled by a push buttons. switch. The fan switch has four positions: HIGH, MED, LOW and OFF. The light switch has two positions, ON and OFF.

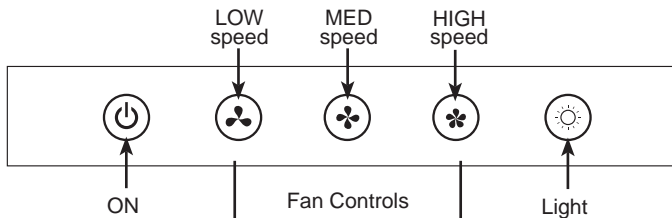

TROUBLESHOOTING

ISSUE	CAUSE	SOLUTION
Unit doesn't work after installation.	1. The power source is not turned ON.	1. Ensure power is ON for the circuit breaker and unit.
	2. The power line and the cable locking connector are not connected properly.	2. Check the power connection with the unit is connected properly.
	3. The unit does not turn on when it is at full extension (SS130 only).	3. Check if the slide control is turned off or set to 0.
Light indicates power ON but motor doesn't turn.	1. The motor is defective, possibly seized.	1. Change the motor. Servicing may be required.
	2. The motherboard is defective.	2. Change defective part. Servicing may be required.
The unit vibrates.	1. The motor is not secured.	1. Tighten the motor in place.
	2. Damaged blower wheel.	2. Replace the blower wheel. Servicing may be required.
	3. The hood is not secured in place.	3. Check the installation of the hood.
	4. Venting duct too small or blockage in the duct opening or ductwork.	4. Check the venting duct and the wall cap or roof cap.
Motor works but lights do not turn on.	1. Defective halogen bulb.	1. Change the halogen bulb.
	2. The light bulb is loose.	2. Tighten the light bulb.
The hood is not venting out properly.	1. The hood might be hanging too high from the cook top.	1. Adjust the distance between the cook top and the bottom of the hood within 28" - 36" above the range.
	2. Blockage in the duct opening or ductwork.	2. Remove all the blocking from the duct work or duct opening.
	3. Using the wrong size of ducting.	3. Use at least 6" duct work.

CYCLONE RANGE HOODS LIMITED WARRANTY

North American Range Hoods Inc. (hereunder called "The Company") provides a warranty that its products are free from defects in workmanship and materials for a period of two (2) years from the date of purchase. This warranty includes in-home service (where applicable) for the first year and workshop service for the second year. During that time period, The Company will, at the Company's option, repair or replace without charge any parts or complete unit found to be defective. Further, the warranty for the motor extends for an additional eight (8) years, with labor costs extra. This warranty is not transferrable from the original purchaser. The company reserves the right to use functionally equivalent reconditioned parts or products as warranty replacement or as part of warranty service.

THE COMPANY WILL NOT BE HELD RESPONSIBLE FOR ANY CLAIMS OVER THE ORIGINAL PURCHASE PRICE OF THE PRODUCTS NOR BE LIABLE FOR INCIDENTAL, CONSEQUENTIAL OR SPECIAL DAMAGES ARISING OUT OF OR IN CONNECTION WITH PRODUCT USE OR PERFORMANCE.

Some provinces do not allow the exclusion or limitation of incidental or consequential damages, so the above limitation or exclusion may not apply to you.

In-home service will be made available only in areas where a contracted service provider offers services. If customer outside the service area, additional charges may apply for shipping costs for warranty repair or replacement. The unit removal and reinstallation works are under the customer responsibility.

This warranty does not cover any costs related to the products including to but not limited to:

- a) Normal maintenance service required for the products; b) light bulbs, plastic grease collector cups, filters, ducts, roof caps, wall caps and other accessories for ducting; c) natural wear of the finish of the products or wear caused by improper maintenance, use of corrosive and abrasive cleaning products; d) products or parts which have been subject to freight damage, misuse, negligence, accident or any other circumstances beyond the control of The company.
- i. The warranty will be automatically void if any of the following apply:
- ii. Commercial use of the products or use otherwise inconsistent with its intended purpose;
- iii. The function of part or the complete assembly has been modified or repaired by unauthorized person;
- iv. Faulty installation or installation contrary to recommended installation instructions:
 - **The hood installed at less than 28" minimum above the range surface;**
 - **Ventilation system has not been vented to the outside or ventilation system stuck;**
 - **Less than 6" round or equivalent ductwork has been used anywhere in the venting system for models with 550 CFM or more CFM;**
 - **The venting duct turned downward anywhere in the venting system;**
 - **Wrong electrical wire connection for the fan.**

To qualify for warranty service you must: (a) notify us at the address telephone number stated below within 2 days of the discovery of the defect; (b) provide the model number and serial number; and (c) describe the nature of any defect in the product or part.

At the time of requesting for service, you must present evidence of your proof of purchase and proof of the original purchase date. If we determine that the warranty exclusions listed above apply or if you fail to provide the necessary documentation to obtain service, customer will be responsible for all shipping, travel, labor and other costs related to the service

For warranty services or repair. Please contact the dealer from whom you purchase the product or the address shown below.

North America Range Hoods Inc.
1361 Huntingwood Drive, Unit 16
Scarborough, ON M1S 3J1
Tel: 1-888-293-5662 or (416) 293-0933 Fax (416) 293-4793
Email: Info@CycloneRangeHoods.com
Website: www.CycloneRangeHoods.com